

INTENSOR SURGICAL TROFFER

Ag7900 Series with Extra High Intensity Light Output



EXTRA HIGH INTENSITY

Designed for traditional Cardiac Surgery requiring illumination for work in both the chest cavity (grafts) and legs (vein harvesting). Should be layed out to provide 600-800 fc illumination over the entire operating table. The traditional large adjustable boom mounted surgery fixture is not necessary. Additional high intensity lighting specific to the graft is typically provided by the procedure light worn on the surgeon's head.

T5HO lamps with a heat sync system to dissipate heat, extending the life of the ballasts and lamps and providing extra high light output.



NEW!
Dual lenses to facilitate ease of cleaning. One asymmetric lens and one clear polycarbonate underlay stadard.

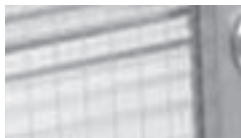

Silver EMI Grid

Reduces electrical interference with sensitive medical equipment (interior, backside view of lens).

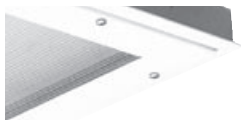

Drop Door Lens

Allows easy access to lamps and ballasts.



Closed Cell Gasketing
Eliminates the "breeding ground incubator" associated with conventional fixtures.

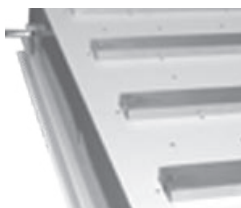

Special Heat Sinks
Allows heat from ballasts and lamps to dissipate up through ceiling plenum

Specifications

Construction: 20 GA die formed steel housing with welded seams. Univeral housing for flange or 1" or 1-1/2" grid ceilings. Topped by a series of heat syncs, effectively dissipating heat generated by the high intensity lamps.

Door: 18 GA cold rolled steel drop down door and lens retaining angles. Optional 18 GA stainless steel door provided only when specified. Optional steel piano hinge spot welded to door frame. Stainless hinge when optional stainless door is specified.

Latches: Captive phillips head screws with cage nuts.
Shielding: Asymmetric acrylic lens with silver based 3/8" grid pattern to provide RFI shielding and clear polycarbonate underlay. Meets MIL standards for EMI suppression.

Gasketing: Closed cell foam gasket above inner door edges and around perimeter of housing flange.
Compliance: ETL (US/Canada) & NSF. Complies with FCC Part 18 and MIL-STD 461C, D & E for control of radiated and conducted electromagnetic interference (EMI).

Electrical: T5HO electronic ballasts standard. One electronic ballast RIF suppressor per ballast.

emergency power packs must be remote mounted.
Lamps: 54W T5 HO white lamps included. Also available in green T5HO.

Heat Sync: Series of heat syncs along top surface of housing safely and effectively dissipates increased heat generated by greater number of T5 HO lamps.
Mounting: Universal housing for flange or 1" or 1-1/2" grid ceilings. Units to be secured above plenum with cable, rod or chain by others. Grid: inverted T-Grid ceiling system by others.

Flange: Two 14 GA galvanized cross mounting yokes provided. Sway brackets and flange kit standard. Optional plaster frame , field assembled, supplied only when specified.

Finish: All metal components pretreated and finished with white powder coating 90% reflectance. Optional stainless door available.

Antimicrobial: AgION™ Antimicrobial protection using silver technology inhibits bacterial colonization on interior and exterior surfaces. Agion™ antimicrobial FDA recognized and EPA registered, meeting all applicable EPA standards.



Also available with 500K 550NM green lamps in T5HO.



Specifier's Reference

Project Name	Type
Catalog No.	
Comments	

INTENSOR SURGICAL TROFFER

Ag7900 Series with Extra High Intensity Light Output



Ordering Information

SERIES	NUMBER LAMPS	LAMP COLOR	MOUNTING STYLE	DOOR	BALLAST	VOLTAGE	LENS	OPTIONS
Ag7924 2X4 Sealed Surgical Troffer with 5000K lamps & 1 RIF suppressor per ballast supplied	-8 (8) 5000K Lamps in 2X4 only (54W T5HO)	-W All 5000K White	-R Recessed Mounted For 1" or 1-1/2" lay-in grid ceiling or dry-wall ceilings	-DD Drop Down Door (Standard)	-T5HO	-120V -277V	-A Asymmetrical -S Symmetrical	-EMP1+ Emergency power pack for 1 circuit, 1 lamp -EMP2+ Emergency power pack for 1 circuit, 2 lamps -GEN1+ Single lamp 5-minute interim battery backup -GMF GMF slow blow fuse and fuse holder -SD Stainless steel door frame -FH GLR fuse and HLR holder set -PF Plaster frame
Ag7922 2X2 Sealed Surgical Troffer with 5000K lamps & 1 RIF suppressor per ballast supplied	-6 (6) 5000K Lamps in 2X2 only (24W T5HO)	-G (2) 5000K Green, the balance 5000K White		-HD Hinged Door				
Ag7914 1X4 Sealed Surgical Troffer with 5000K lamps & 1 RIF suppressor per ballast supplied	-4 (4) 5000K Lamps in 1X4 only (54W T5HO)							

LAMPS INCLUDED!

Mounting & Dimensions

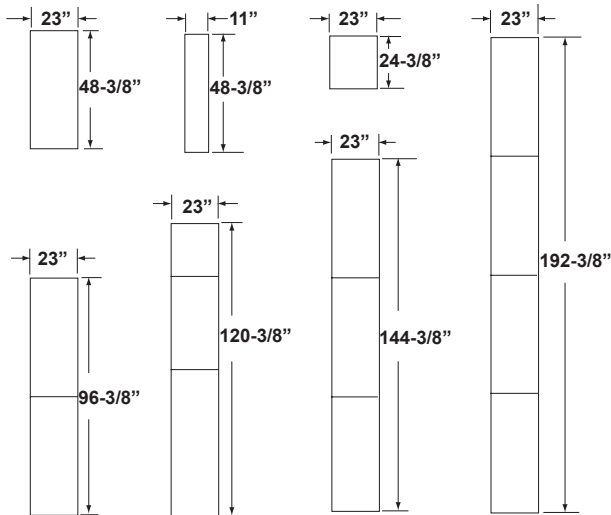

	A	B	C	D	E	F	G
2X4	22-3/4"	23-3/4"	24"	47-11/32"	48-11/32"	7"	11/16"
2X2	22-3/4"	23-3/4"	24"	23-11/32"	24-11/32"	7"	11/16"
1X4	10-3/4"	11-3/4"	12"	47-11/32"	48-11/32"	7"	11/16"

A HOUSING LESS FLANGE
 B WIDTH HOUSING & FLANGE
 C INVERTED T-GRID
 D HOUSING LENGTH
 E HOUSING & FLANGE LENGTH
 F HOUSING DEPTH
 G HEAT SINK DEPTH

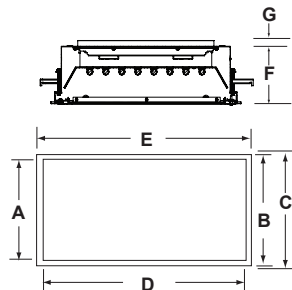

Photometrics

Catalog # Ag7924
 Luminaire Efficiency: 75.3%
 Lamps: 8-F54T5/850/HO, 5000K
 Input Wattage: 432 watts
 Ballast Type: Electronic
 Ballast Factor: 1.0
 Report Ref: 2.0.0.17

Floor Ceilings	20%										
	80%			70%			50%				
Walls(%)	70	50	30	10	70	50	30	10	50	30	10
0	90	90	90	90	88	88	88	88	84	84	84
1	82	79	76	73	80	77	74	72	74	72	70
2	75	69	64	60	73	68	63	60	65	62	58
3	69	61	56	51	67	60	55	50	58	53	50
4	63	55	48	44	62	54	48	43	52	47	43
5	59	49	43	38	57	48	42	38	47	41	37
6	54	44	38	33	53	44	38	33	42	37	33
7	50	40	34	30	49	40	34	29	39	33	29
8	47	37	31	26	46	36	30	26	35	30	26
9	44	34	28	24	43	34	28	24	33	27	24
10	41	31	26	22	40	31	25	22	30	25	21

